



FOR LEASE: 927 MAIN STREET (RT 28), WEST DENNIS



- ◆ **Retail space located at the lighted intersection of Route 134 and Route 28 (Main Street) in Dennis, in building with Dunkin' Donuts (Route 134 turns in to Swan River Road on the south side)**
- ◆ **1,200 sq. ft. space with large display windows in the front and also windows on the side. Signage on the building and on the free-standing street sign**
- ◆ **Current layout is two open rooms and an ADA compliant bathroom**
- ◆ **Large parking lot with two curb cuts. Major intersection with right and left turn lanes**
- ◆ **Across from the Rockland Trust Bank, the Kream 'n Kone & 7-Eleven**

ASKING \$2,200 per month

Exclusively Listed by Ali Maloney- AMG Realty

Bus: 508.362.3323

Cell: 774.836.0347

aamaloney@comcast.net

The information contained herein is believed to be accurate, and has been derived from sources deemed reliable. The providers of this package expressly disclaim any and all liability, express or implied for any information, representations, projections, contained herein, or for any omissions from the document, including, but not limited to all other forms of documentation that may be communicated to any party during the course of evaluating this transaction.

927 MAIN STREET (RT 28), WEST DENNIS



AMG REALTY

Above— This view is from the entrance of the space. Oversized windows facing north and west. The opening leads to the back room, bathroom and rear egress.



AMG REALTY

Above— The front room is approximately 27' x 20' This picture is looking towards the entrance and Route 28.



927 MAIN STREET (RT 28), WEST DENNIS



Above-
Back room measuring approximately 23' x 21' looking towards opening to the front.



Above-
Back of the building showing the rear egress and ramp.
Ample parking and second curb cut onto Swan River Rd.



927 MAIN STREET (RT 28), WEST DENNIS

1,200 Sq. Ft.

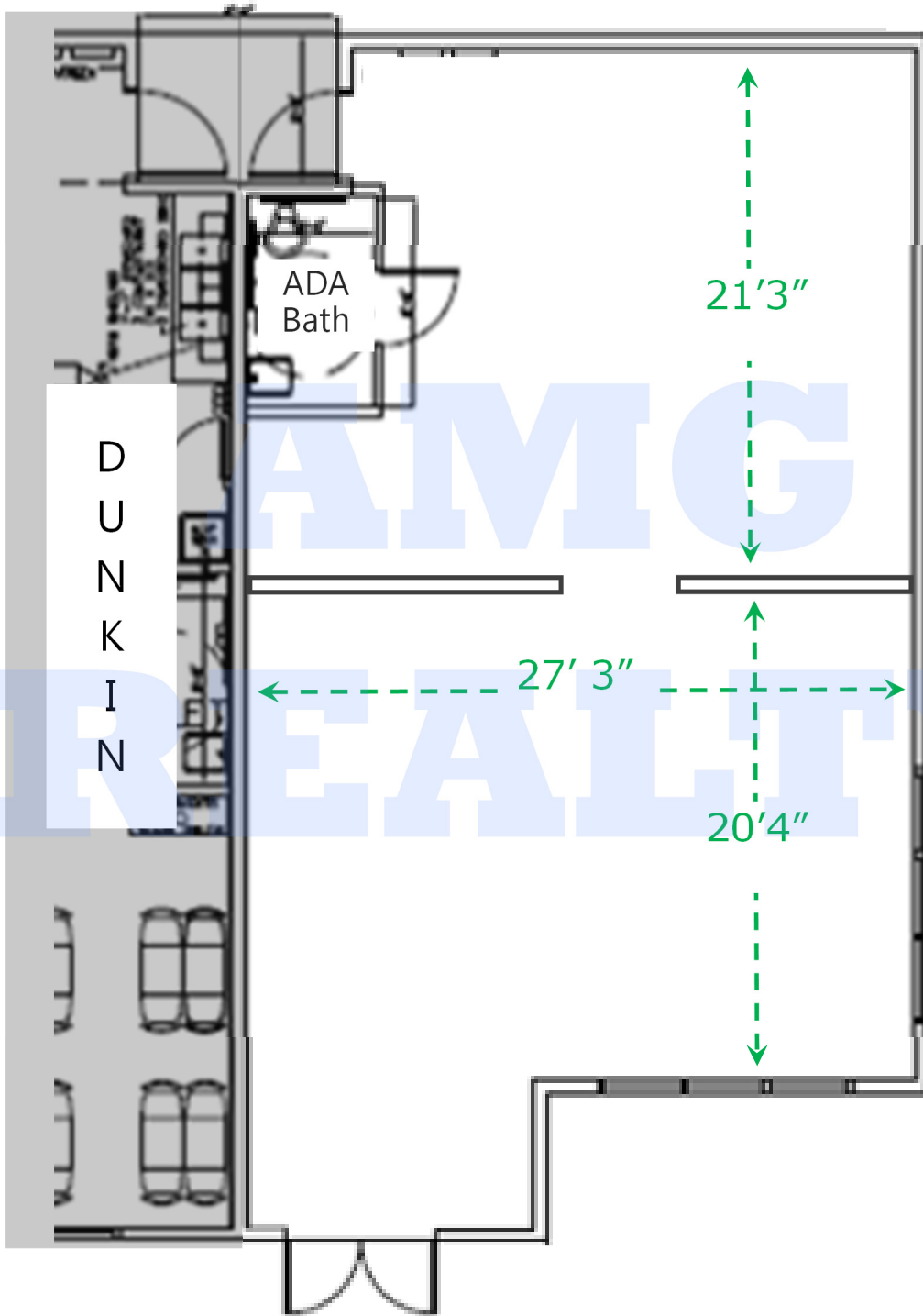

Measurements are approximate. Not to scale.

www.AMGRealty.net